

Connectors and Cable Sets

Standard Directional Control Valves

Male Receptacles

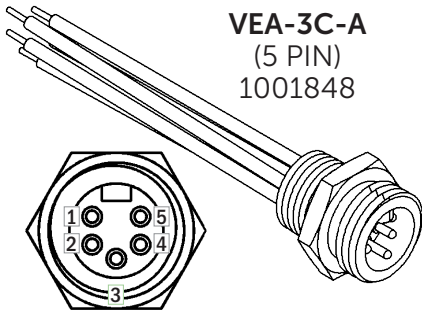

VEA-3C-A
(5 PIN)
1001848

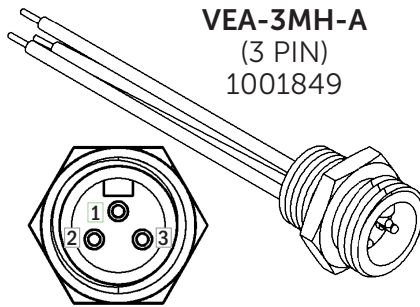

VEA-3MH-A
(3 PIN)
1001849

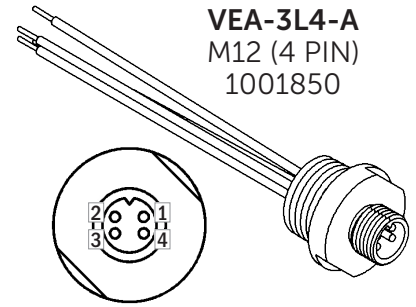

VEA-3L4-A
M12 (4 PIN)
1001850

Five Pin Connector Codes B5A, B5H Use with single or double solenoid valve	
1	Leads to Solenoid B
2	Leads to Solenoid A
3	Green (Ground) Lead
4	Leads to Solenoid A
5	Leads to Solenoid B

Three Pin Connector Codes B3A, B3H Use with single solenoid valve	
1	Green (Ground) Lead
2	Leads to Solenoid
2	Leads to Solenoid

Four Pin Micro-Connector Codes B4, B4A Use with single or double solenoid valve Available with 2-pin DC coils only	
1	Leads to Solenoid B
2	No Connection
3	Common Lead to Solenoid A & B
4	Leads to Solenoid A

Female Receptacles

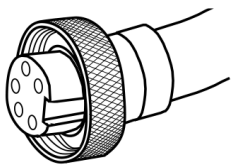

VEA-3D-A
(5 PIN)
160415
(9 ft. cord)

VEA-3M-A
(3 PIN)
264051
(9 ft. cord)

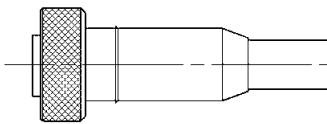

VEA-3L-A
(M12 4 PIN)
264054
(9 ft. cord)

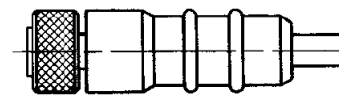

DIN Connector
43650 Form A / ISO 4400
PC11 ISO Strain Relief

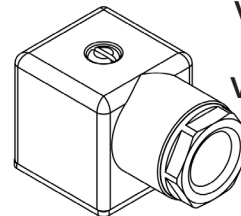

VEA-3E-A (Grey)
165639

VEA-3F-A (Black)
165638

VEA-DT06-C5-A
1021639DC
(Deutsch)

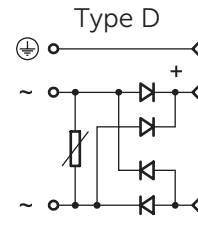
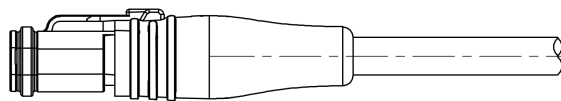

VEA-6FR-A
1008400
Built in Graetz
Bridge Rectifier

Two poles + ground with Graetz bridge rectifier: for alternate current power supply source and direct current coils with current consumption max 1 ampere.

For Valves with Integrated Electronics

MATING CONNECTORS FOR MAIN CONNECTION

1 - FOR STD CONNECTION - 6 PIN+PE (female)

standard: MIL-C-5015-G (EN 175201-804)

VEA-3P7P-B code: 264893 Plastic connector

VEA-3P7M-B code: 265947 Metal connector

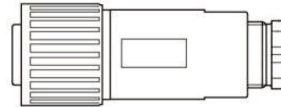

1.1 - CORD SETS FOR STD CONNECTION - 6 PIN+PE

VEA-3P7C-C3-B Plastic connector with 3 meter cord code: 1013946

VEA-3P7C-C6-B Plastic connector with 6 meter cord code: 1019090

VEA-3P7C-C10-B Plastic connector with 10 meter cord code: 1018859

VEA-3P7M-C3-B Metal connector with 3 meter cord code: 1023374

VEA-3P7M-C6-B Metal connector with 6 meter cord code: 1023591

VEA-3P7M-C15-B Metal connector with 15 meter cord code: 1019573

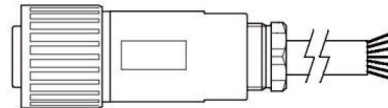

2 - FOR K12 CONNECTION - M12 5 PIN

VEA-3P5-B code: **M3491001001** CH

M12 connector, 5-poles, code A, female, IP65/67 glass filled plastic

standard: IEC 61076-2-101

suitable cables: Ø9 mm, up to 20 metres length

conductor size: 0.75 mm²

contacts: screw contacts

shield: yes

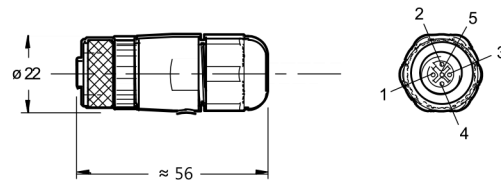

2.1 - CORD SETS FOR M12 5 PIN

VEA-3P5-C5-B Plastic connector with 5 meter cord code: 1014269

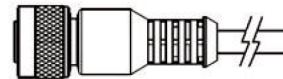

3 - FOR K16 CONNECTION - 11 PIN+PE

VEA-3P12M-B code: **M3890000004** CH

Metal connector 11 poles + PE, shielded

standard: DIN 43651 (EN 175201-804)

suitable cables: Ø15 mm up to 10 metres length

conductor size: max 0.5 mm²

contacts: crimp contacts

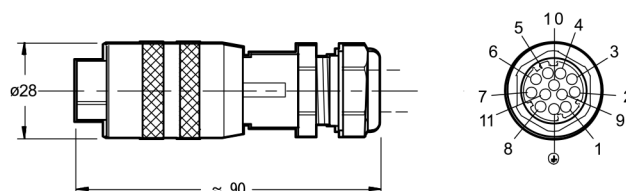

Connectors and Cable Sets

4 - MATING CONNECTORS FOR FIELDBUS COMMUNICATION

We offer metal connectors IEC 61076-2-101, shielded, with screw connection, IP 67

4.1 - CANopen®

VEA-3P5M-CO-B

code M3890000008 CH

connector M12 A 5 pin; external cable diameter 4 ÷ 6 mm
(X2) male

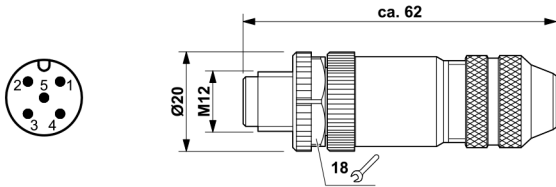

VEA-3P5F-CO-B

code M3890000007 CH

connector M12 A 5 pin; external cable diameter 4 ÷ 6 mm
(X3) female

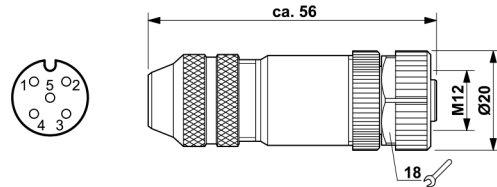

4.2 - Profibus

VEA-3P5F-PB-B

code M3890000005 CH

connector M12 B 5 pin; external cable diameter 6.5 ÷ 8.5 mm
(X2) female

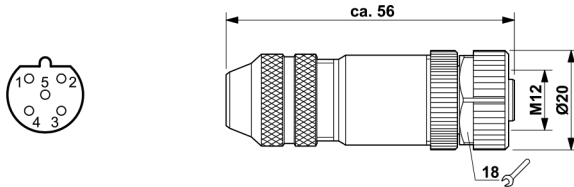

VEA-3P5M-PB-B

code M3890000006 CH

connector M12 B 5 pin; external cable diameter 6.5 ÷ 8.5 mm
(X3) male

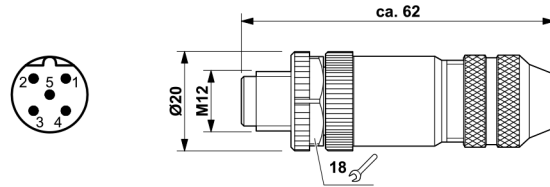

4.3 - EtherCAT, Ethernet/IP, Profinet, Powerlink

VEA-3P5M-EP-B

code M3890000009 CH

connector M12 D 4 pin; external cable diameter 4 ÷ 6 mm
(X2, X3) male

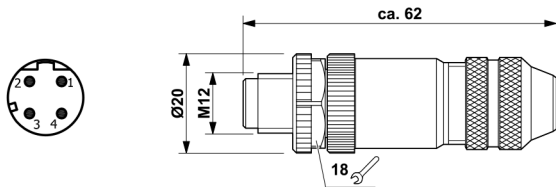

5 - TRANSDUCER MATING CONNECTORS

VEA-3P8M-B

code M3890000011 CH

connector for digital sensor type SSI / Encoder M12 A 8 pin
external cable diameter 6 ÷ 8 mm
(X7) male

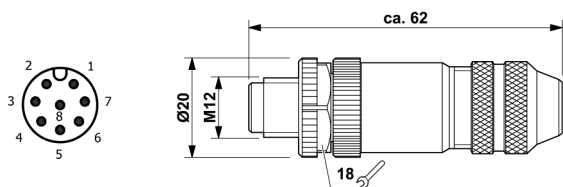

VEA-3P4-B

code M3890000010 CH

connector for analogue sensor M12 A 4 pin
external cable diameter 4 ÷ 6 mm
(X4) male

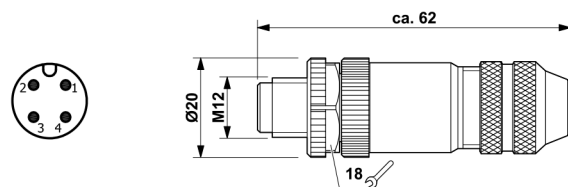

Connectors and Cable Sets

6 - CABLES SETS

We can supply cable sets for fieldbus communication connections X3 to X2 and sensor cables for X7 and X4 ports on request.

All cables are PUR halogen-free.

These molded cables are equipped with 'speed connect' connectors that allow a smaller overall than conventional connectors.

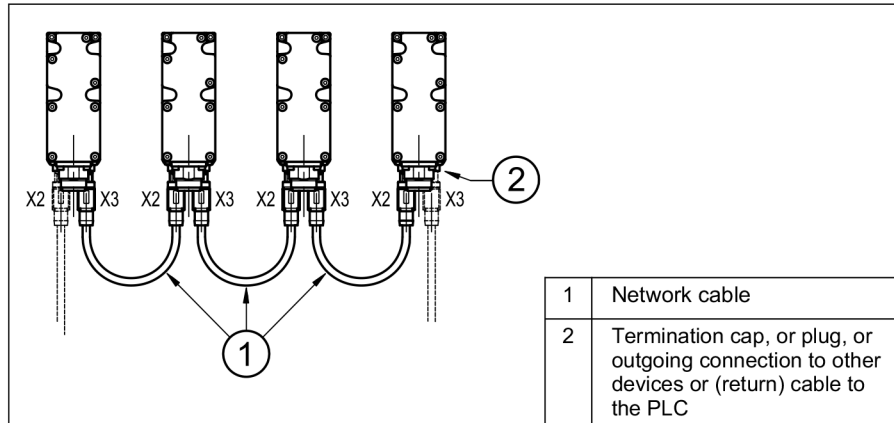

6.1 - Fieldbus cables X3 to X2

Fieldbus type

Cable description

CANopen®
VEA-3P5C-CO-B
code: M3890001001CH

Bus system cable, CANopen®, DeviceNet™, shielded.
 cable length: 0.5 m
 Plug straight M12 code A - Socket straight M12 code A
 IP65 / IP67
 ambient temperature: -25 + 90 °C

Circuit diagram

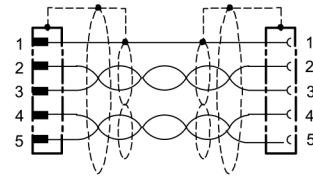

ProfiBus DP
VEA-3P5C-DP-B
code: M3890001002CH

Bus system cable, PROFIBUS (12 Mbps), shielded
 cable length: 0.5 m
 Plug straight M12 code B - Socket straight M12 code B
 IP65 / IP67
 ambient temperature: -25 + 90 °C

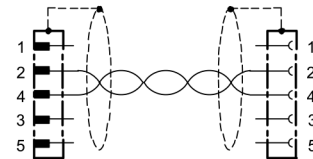

Ethernet:
VEA-3P5C-EP-B
code: M3890001003CH
 EtherCAT
 Ethernet/IP
 Profinet
 Powerlink

Network cable, Ethernet CAT5 (100 Mbps), shielded.
 cable length: 0.5 m
 Plug straight M12 code D - plug straight M12 code D,
 IP67
 ambient temperature: -25 + 85 °C

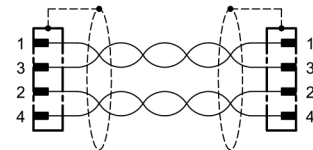

6.2 - Sensor / actuator cables

Sensor type

Cable description

Analogue (X4)
VEA-3P4DS-B
code: M3890001004CH

Sensor/actuator cable
 cable length: 0.6 m
 Plug straight M12 code A - double socket straight M12 code A
 IP65 / IP67
 ambient temperature: -25 + 90 °C

Circuit diagram

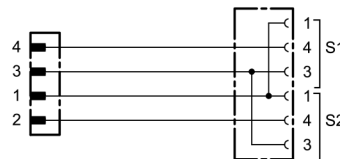

Digital SSI / Encoder (X7)
VEA-3P8M-C3-B
code: M3890001005CH

Sensor/actuator cable, shielded,
 cable length: 3 m
 Plug straight M12 code A - free cable end, unwired
 ambient temperature: -25 + 90 °C

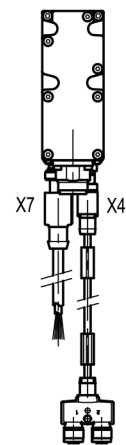
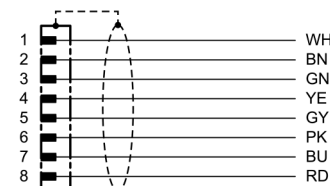

Hazardous Location Cable Glands

VSD-HL-KD2
VED-HL-KD2
VSD-EXA

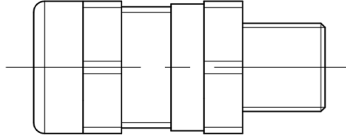

Item	Description
M3908108001	M20 x 1.5 - ISO 261 Male Tread
M3908108002	Version with Gk 1/2 - UNI EN 10226-2 Male Tread
M3908108003	Version with 1/2" NPT - ANSI B1.20.1 (ex ANSI B2.1)
M3908108004	Version with M16 x 1.5 - ISO 261 Male Tread